



PROJECT		REF		REV	ITEM CODE	
LOCATION		DATE			PAGE	

**SANITARY WARE SPECIFICATION SHEET**

<p>Item Descriptions</p>	<p>American Standard (PRC) Chrome plated extended sensor faucet with Line-Sensor Technology, 6V alkaline battery DC</p>	<p align="center">Illustration/ Drawing</p>
<p>Dimensions</p>	<p>L165 x W45 x H253 mm</p>	
<p>Model</p>	<p>CF-8507.D00.50</p>	
<p>Finish</p>	<p>Chrome Plated</p>	
<p>Manufacturer</p>	<p>American Standard (PRC)</p>	
<p>Source</p>	<p>Acme Sanitary Ware Co. Ltd          Mr. Eric Wong / Mr. Don Yuen</p>	
<p>Contact Tel/Fax</p>	<p>(852) 2388-7171 / (852) 2710-8012</p>	
<p>E-mail</p>	<p>acme@acmesanitary.com.hk</p>	
<p>Website</p>	<p>www.acmesanitary.com.hk</p>	
<p>Line sensor at the spout          With PCA aerator to ensure stable water flow under high pressure          Safety stop at 59 sec          6V alkaline battery</p> <ul style="list-style-type: none"> <li>Consisting of 64-light receiving elements mounted in a straight line at the spout, American Standard's Line Sensor comes equipped with Image Processing Technology to provide unmatched sensor precision compared to a conventional sensor faucet.</li> <li>The streamlined designed faucets also feature aerated water flow to prevent water splashing, offering you an unparalleled experience of both aesthetics and performance for your commercial projects.</li> </ul>		

Note: Equivalent to WF-8507.D00 / FFAS8507-D00500BC0

\* All information of the above is for reference only. No prior notice is made if any changes.



# Acme Sanitary Ware Co. Ltd.

1/F, Acme Building, 22-28 Nanking Street, Kowloon, Hong Kong

Tel: 2388 7171 Fax: 2710 8012

Email: acme@acmesanitary.com.hk

Website: www.acmesanitary.com.hk

Since 1949

## American Standard

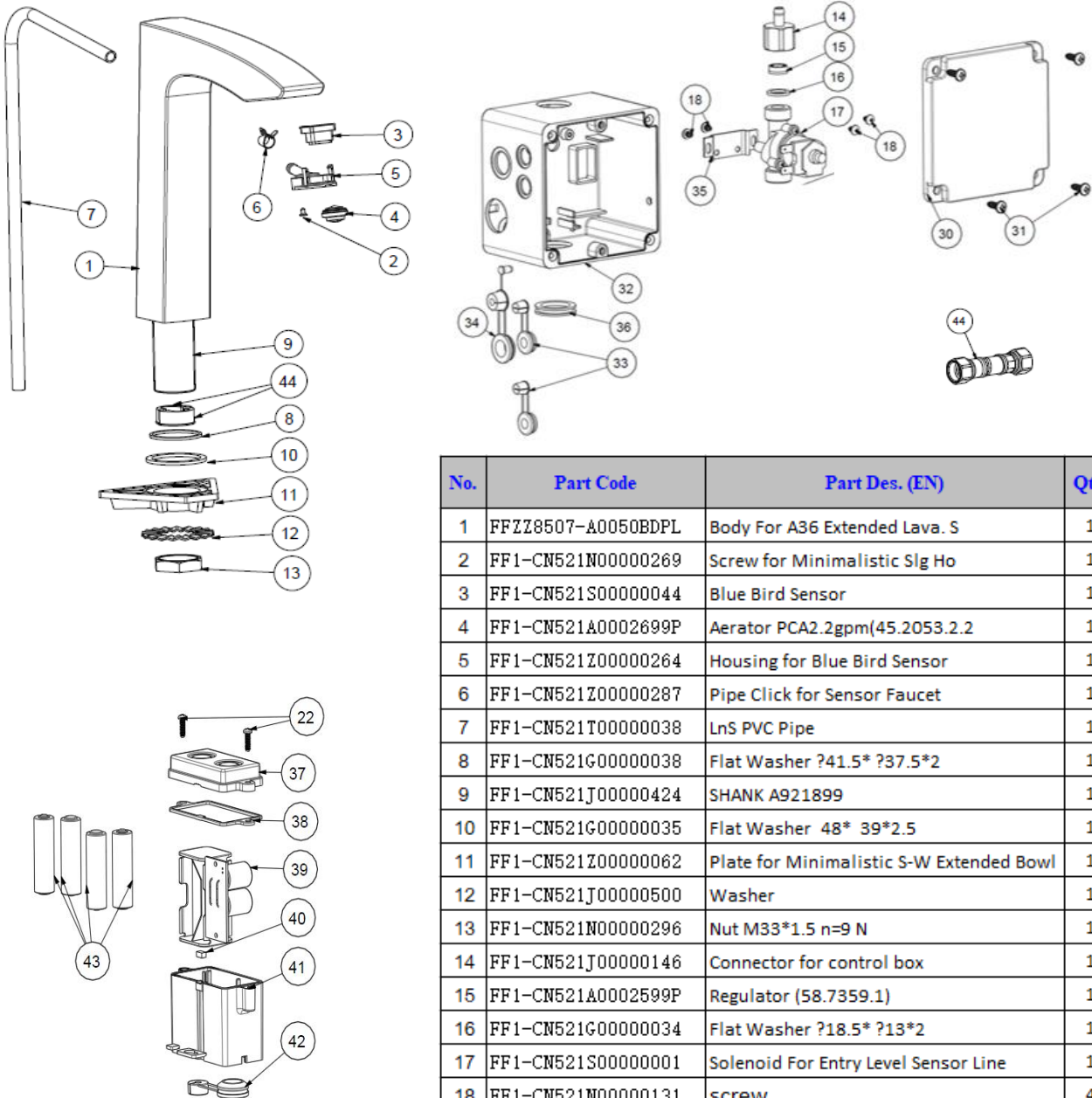

No.	Part Code	Part Des. (EN)	Qty.
1	FFZZ8507-A0050BDPL	Body For A36 Extended Lava. S	1
2	FF1-CN521N00000269	Screw for Minimalistic Slg Ho	1
3	FF1-CN521S00000044	Blue Bird Sensor	1
4	FF1-CN521A0002699P	Aerator PCA2.2gpm(45.2053.2.2	1
5	FF1-CN521Z00000264	Housing for Blue Bird Sensor	1
6	FF1-CN521Z00000287	Pipe Click for Sensor Faucet	1
7	FF1-CN521T00000038	LnS PVC Pipe	1
8	FF1-CN521G00000038	Flat Washer ?41.5* ?37.5*2	1
9	FF1-CN521J00000424	SHANK A921899	1
10	FF1-CN521G00000035	Flat Washer 48* 39*2.5	1
11	FF1-CN521Z00000062	Plate for Minimalistic S-W Extended Bowl	1
12	FF1-CN521J00000500	Washer	1
13	FF1-CN521N00000296	Nut M33*1.5 n=9 N	1
14	FF1-CN521J00000146	Connector for control box	1
15	FF1-CN521A0002599P	Regulator (58.7359.1)	1
16	FF1-CN521G00000034	Flat Washer ?18.5* ?13*2	1
17	FF1-CN521S00000001	Solenoid For Entry Level Sensor Line	1
18	FF1-CN521N00000131	Screw	4
30	FF1-CN521F00000048	COVER	1
31	FF1-CN521N00000239	EJOT-PT-SCREW KB50*16(A918549	4
32	FF1-CN521Z00000286	CONTROL BOX	1
33	FF1-CN521G00000306	New Grommet	1
34	FF1-CN521Z00000081	Rubbler Plug for Control Box(	1
35	FF1-CN521F00000181	Fixing Board for Solenoid	1
36	FF1-CN521Z00000080	Rubbler plug for battery box	1
37	FF1-CN521F00000059	Cover for EL battery box(trans	1
38	FF1-CN521G00000085	Sealing washer for cover of b	1
39	FF1-CN521S00000045	Blue Bird PC Board DC	1
40	FF1-CN521G00000086	Sealing washer for body of ba	1
41	FF1-CN521Z00000057	Body for EL battery box(trans	1
42	FF1-CN521Z00000079	Rubbler plug for control box	1
43	FF1-CN521S00000023	Alkaline Battery (AA)	4
44	FF1-CN521T00000008	GS-1 In-Water Hose 1/2inch*45	1

\* All information of the above is for the reference only. No prior notice is made if any changes.